



LEGAL DESCRIPTION
PORTION OF TRACT OS-9 TO LOT 12-22

THAT PORTION OF TRACT OS-9, PHASE 3, DIVISION 11 OF THE PLAT OF SUNCADIA (TUMBLE CREEK), RECORDED IN BOOK 9 OF PLATS, PAGES 245 THROUGH 251, UNDER AUDITOR'S FILE NUMBER 200512070002, RECORDS OF KITITIAS COUNTY, STATE OF WASHINGTON WHICH IS BOUNDED BY A LINE DESCRIBED AS FOLLOWS:

BEGINNING AT THE SOUTHERLYMOST CORNER OF LOT 12-22, PHASE 3, DIVISION 12 OF THE PLAT OF SUNCADIA (TUMBLE CREEK), RECORDED IN BOOK 10 OF PLATS, PAGES 121 THROUGH 126, UNDER AUDITOR'S FILE NUMBER 200608020001, RECORDS OF KITITIAS COUNTY, STATE OF WASHINGTON, WHICH IS THE TRUE POINT OF BEGINNING OF SAID LINE:

THENCE NORTH 32°37'15" EAST ALONG THE SOUTH LINE OF SAID LOT 12-22, 35.17 FEET; THENCE SOUTH 84°26'58" EAST ALONG THE SOUTH LINE OF SAID LOT 12-22, 46.83 FEET; THENCE SOUTH 69°03'32" WEST, 70.21 FEET TO THE TRUE POINT OF BEGINNING AND TERMINUS OF SAID LINE.

SITUATED IN THE NORTHEAST QUARTER OF SECTION 23, TOWNSHIP 20 NORTH, RANGE 14 EAST, W.M., KITITIAS COUNTY STATE OF WASHINGTON.

CONTAINING 0.02 ACRES.

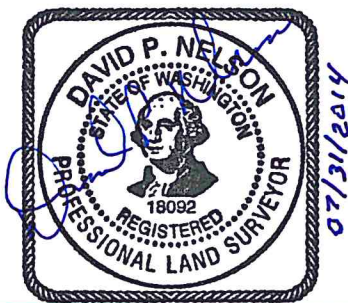

Western Washington Division
165 NE Juniper St., Ste 201, Issaquah, WA 98027
98922
Phone: (425) 392-0250 Fax: (425) 391-3055
674-7419

Eastern Washington Division
108 East 2nd Street, Cle Elum, WA
Phone: (509) 674-7433 Fax: (509)

LEGAL DESCRIPTION
REVISED TRACT OS-9



TRACT OS-9, PHASE 3, DIVISION 11 OF THE PLAT OF SUNCADIA (TUMBLE CREEK), RECORDED IN BOOK 9 OF PLATS, PAGES 245 THROUGH 251, UNDER AUDITOR'S FILE NUMBER 200512070002, RECORDS OF KITTTIAS COUNTY, STATE OF WASHINGTON, EXCEPT THAT PORTION WHICH IS BOUNDED BY A LINE DESCRIBED AS FOLLOWS:

BEGINNING AT THE SOUTHERLYMOST CORNER OF LOT 12-22, PHASE 3, DIVISION 12 OF THE PLAT OF SUNCADIA (TUMBLE CREEK), RECORDED IN BOOK 10 OF PLATS, PAGES 121 THROUGH 126, UNDER AUDITOR'S FILE NUMBER 200608020001, RECORDS OF KITTTAS COUNTY, STATE OF WASHINGTON, WHICH IS THE TRUE POINT OF BEGINNING OF SAID LINE:

THENCE NORTH 32°37'15" EAST ALONG THE SOUTH LINE OF SAID LOT 12-22, 35.17 FEET; THENCE SOUTH 84°26'58" EAST ALONG THE SOUTH LINE OF SAID LOT 12-22, 46.83 FEET; THENCE SOUTH 69°03'32" WEST, 70.21 FEET TO THE TRUE POINT OF BEGINNING AND TERMINUS OF SAID LINE.

SITUATED IN THE NORTHEAST QUARTER OF SECTION 23, TOWNSHIP 20 NORTH, RANGE 14 EAST, W.M., KITTTAS COUNTY STATE OF WASHINGTON.

CONTAINING 1.05 ACRES.



LEGAL DESCRIPTION
REVISED LOT 12-22



LOT 12-22, PHASE 3, DIVISION 12 OF THE PLAT OF SUNCADIA (TUMBLE CREEK), RECORDED IN BOOK 10 OF PLATS, PAGES 121 THROUGH 126, UNDER AUDITOR'S FILE NUMBER 200608020001, RECORDS OF KITTITAS COUNTY, STATE OF WASHINGTON.

AND

THAT PORTION OF TRACT OS-9, PHASE 3, DIVISION 11 OF THE PLAT OF SUNCADIA (TUMBLE CREEK), RECORDED IN BOOK 9 OF PLATS, PAGES 245 THROUGH 251, UNDER AUDITOR'S FILE NUMBER 200512070002, RECORDS OF KITTITAS COUNTY, STATE OF WASHINGTON WHICH IS BOUNDED BY A LINE DESCRIBED AS FOLLOWS:

BEGINNING AT THE SOUTHERLYMOST CORNER OF LOT 12-22, PHASE 3, DIVISION 12 OF THE PLAT OF SUNCADIA (TUMBLE CREEK), RECORDED IN BOOK 10 OF PLATS, PAGES 121 THROUGH 126, UNDER AUDITOR'S FILE NUMBER 200608020001, RECORDS OF KITTITAS COUNTY, STATE OF WASHINGTON, WHICH IS THE TRUE POINT OF BEGINNING OF SAID LINE:

THENCE NORTH 32°37'15" EAST ALONG THE SOUTH LINE OF SAID LOT 12-22, 35.17 FEET; THENCE SOUTH 84°26'58" EAST ALONG THE SOUTH LINE OF SAID LOT 12-22, 46.83 FEET; THENCE SOUTH 69°03'32" WEST, 70.21 FEET TO THE TRUE POINT OF BEGINNING AND TERMINUS OF SAID LINE.

SITUATED IN THE NORTHEAST QUARTER OF SECTION 23, TOWNSHIP 20 NORTH, RANGE 14 EAST, W.M., KITTITAS COUNTY STATE OF WASHINGTON.

CONTAINING 0.22 ACRES.

